

## БТС-9252Л, БТС-9256Л

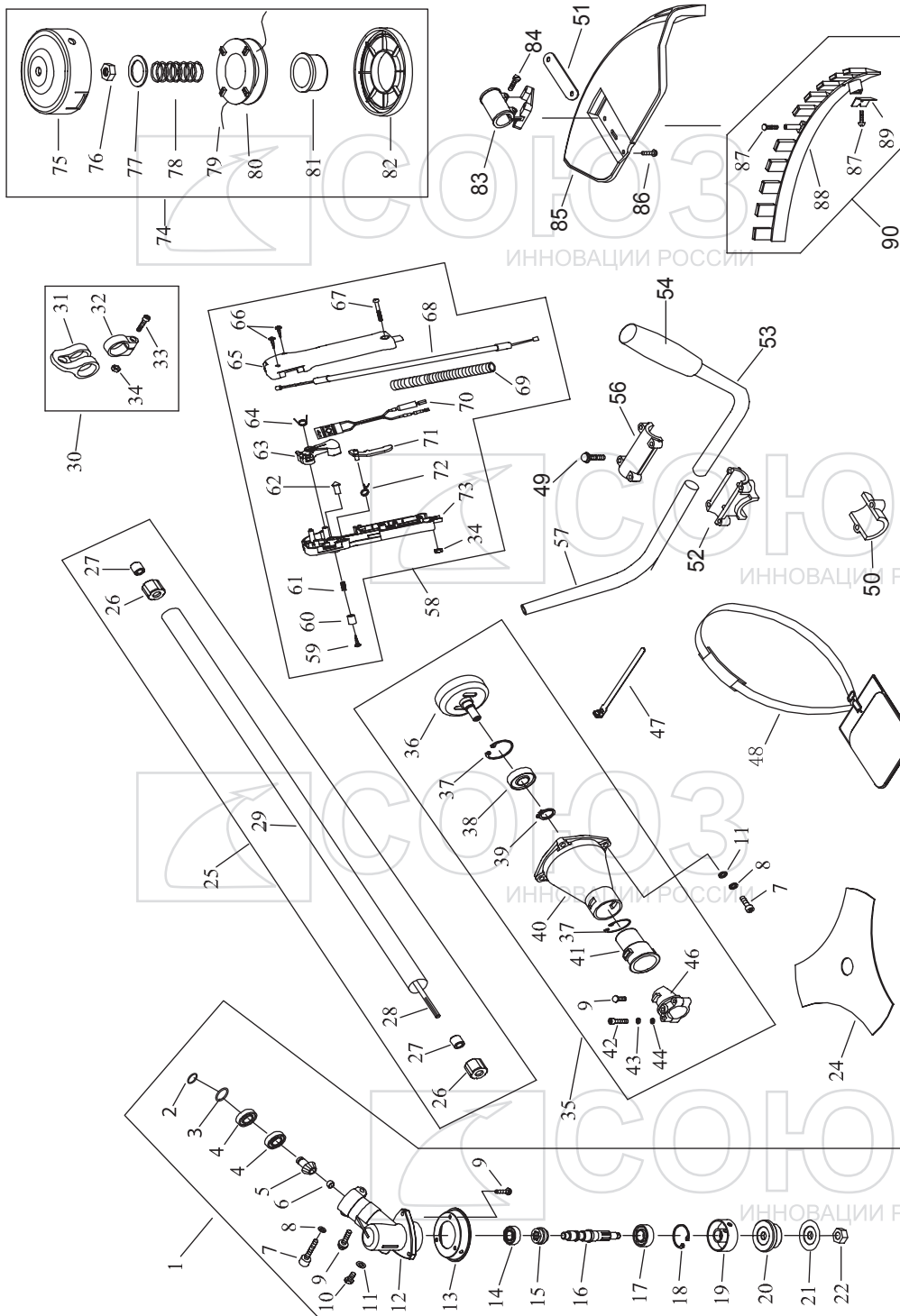

| NO. | DESCRIPTION         | NO. | DESCRIPTION         | NO. | DESCRIPTION       |
|-----|---------------------|-----|---------------------|-----|-------------------|
| 1   | GEAR CASE ASS'Y     | 31  | HARNESS CLAMP       | 62  | CLOCK PIN         |
| 2   | STOP RING           | 32  | CLAMP               | 63  | HANDGRIP          |
| 3   | STOP RING           | 33  | SCREW M5X20         | 64  | SPRING            |
| 4   | BEARING 6000-2RS/P5 | 34  | NUT                 | 65  | BOX,RIGHT         |
| 5   | PINION              | 35  | CLUTCH COMP.        | 66  | SCREW ST2.9X18    |
| 6   | STEEL PLATE CAP     | 36  | CLUTCH DRUM COMP.   | 67  | SCREW M5X30       |
| 7   | SCREW M6X20         | 37  | STOP RING           | 68  | CABLE COMP.       |
| 8   | WASHER              | 38  | BEARING 6202-2RS/P5 | 69  | TUBE              |
| 9   | SCREW M5X12         | 39  | STOP RING           | 70  | STOP BUTTON COMP. |
| 10  | BOLT M6X12          | 40  | LINKER              | 71  | HANDGRIP          |
| 11  | WASHER              | 41  | RUBBER COVER        | 72  | SPRING            |
| 12  | GEAR CASE           | 42  | SCREW               | 73  | BOX,LEFT          |
| 13  | BLADE COVER         | 43  | WASHER              | 74  | NYLON CUTTER HEAD |
| 14  | BEARING 6000/P5     | 44  | WASHER              | 75  | CASE              |
| 15  | GEAR                | 46  | CLAMP               | 76  | LEFT NUT          |
| 16  | GEAR SHAFT          | 47  | WIRE CLAMP BAND     | 77  | WASHER            |
| 17  | BEARING 6002-2RS/P5 | 48  | HARNESS ASS'Y       | 78  | SPRING            |
| 18  | STOP RING           | 49  | SCREW M5X2          | 79  | NYLON CORD        |
| 19  | HOLDER              | 50  | CAP,LOWER           | 80  | CORD HOLDER       |
| 20  | HOLDER              | 51  | WASHER              | 81  | PLATEN            |
| 21  | HOLDER              | 52  | BRACKET             | 82  | COVER             |
| 22  | LEFT NUT            | 53  | HANDLE              | 83  | BRACKET           |
| 24  | BLADE               | 54  | GRIP LEFT           | 84  | SCREW M5X30       |
| 25  | PIPE COMP.          | 56  | CAP,UPPER           | 85  | SAFETY GUARD      |
| 26  | RUBBER COVER        | 57  | HANDLE              | 86  | SCREW M5X16       |
| 27  | OIL-BEARING         | 58  | LEVER ASS'Y         | 87  | SCREW ST4.2X16    |
| 28  | DRIVE SHAFT         | 59  | SCREW ST2.9X13      | 88  | GUARD             |
| 29  | PIPE                | 60  | BUTTON              | 89  | BLADE             |
| 30  | HOLDER ASS'Y        | 61  | SPRING              | 90  | GUARD ASS'Y       |

RU-SO20141030



## БЕНЗОДВИГАТЕЛЬ ДЛЯ БТС-9252Л, БТС-9256Л

| NO. | DESCRIPTION        | NO.   | DESCRIPTION            | NO.  | DESCRIPTION                  |
|-----|--------------------|-------|------------------------|------|------------------------------|
| 9   | SCREW M5X20        | 44    | CYLINDER               | 76   | SCREW M5X16                  |
| 10  | GASKET             | 45    | SCREW                  | 77   | CLEANER COVER                |
| 11  | NUT                | 46    | GUIDE COVER ASS'Y      | 78   | OUTLET FUEL PIPE             |
| 16  | OIL-SEAL           | 47    | SPARK PLUG             | 79   | PLUG                         |
| 17  | CRANK CASE         | 48    | SPRING                 | 80   | INLET FUEL PIPE              |
| 18  | BEARING 6202/P5    | 49    | PLUG COVER             | 81   | FUEL TANK                    |
| 19  | CRANK SHAFT        | 50    | PLUG CAP               | 82   | LID ASS'Y                    |
| 20  | KEY                | 51    | PLUG                   | 82-1 | FUEL TANK LID                |
| 21  | PIN                | 52    | UPPER COVER            | 82-2 | GASKET                       |
| 22  | RUBBER WASHER      | 53    | UPPER COVER            | 82-3 | INLET                        |
| 23  | CRANK CASE         | 54    | GASKET                 | 82-4 | INSIDE COVER                 |
| 24  | FLASH PAN          | 55    | MUFFLER                | 82-5 | LID                          |
| 25  | SCREW M5X30        | 56    | SCREW                  | 82-6 | CHAIN                        |
| 26  | MAGNETO ROTO COMP  | 57    | BOLT                   | 89   | STAND                        |
| 27  | NUT                | 59    | SCREW                  | 90   | GUIDE PLATE                  |
| 28  | IGNITION COLL COMP | 60    | GASKET                 | 91   | SCREW M5X20                  |
| 29  | CORD COMP          | 61    | ADMITTING PIPE         | 92   | BRACKET                      |
| 30  | BOLT M5X20         | 62    | GASKET                 | 93   | STARTER PULLEY ASS'Y         |
| 31  | WASHER B           | 63    | CARBURETOR             | 93-1 | STARTER REEL                 |
| 32  | SPRING             | 69    | STARTER                | 93-2 | STOP RING                    |
| 33  | EXPANDER           | 69-1  | SCREW                  | 93-3 | STARTER PAWL SPRING          |
| 34  | WASHER             | 69-2  | WASHER                 | 93-4 | STARTER PAWL                 |
| 35  | SCREW PIN          | 69-3  | START ROPE REEL        | 94   | CLEANER OUTSIDE COVER        |
| 36  | FAN COVER          | 69-4  | ROPE                   | 95   | CLEANER ELEMENT              |
| 37  | BEARING            | 69-5  | RECOIL SPRING          | 96   | DEFENDER FOR CLEANER ELEMENT |
| 38  | RING               | 69-6  | START COVER ASS'Y      | 97   | SCREW ST4.2X12-F-H           |
| 39  | PISTON             | 69-7  | START HANDLE           | 98   | CHOKE                        |
| 40  | PISTON PIN         | 69-8  | RING                   | 99   | CLEANER INSIDE COVER         |
| 41  | GASKET             | 69-9  | START RATCHET          | 100  | CHOKE HANDLE                 |
| 42  | PISTON RING        | 69-10 | EASY START COIL-SPRING | 101  | SCREW M5X55                  |
| 43  | GASKET             |       |                        |      |                              |

ИННОВАЦИИ РОССИИ

RU-SO20141030

